





commercial interiors





HelixLED | LD 91

Recess mounted circular LED downlighter



APPLICATIONS



SPECIFICATIONS

- Pressure Die cast aluminium housing
- High efficacy LEDs
- High Transmittivity Diffuser
- Specially designed, easy to install mounting clips
- Driver and accessories are pre-wired

INSTALLATION

- Provision for mounting with the help of specially designed mounting clips

DIMENSION DRAWINGS

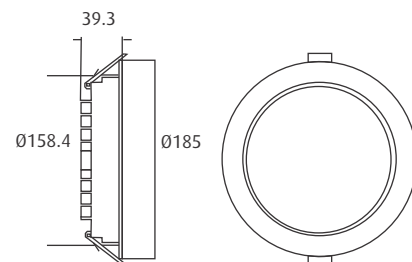

Cutout Dimension: Ø165mm
All dimensions are in mm. Tolerance ± 2 mm

ELECTRICAL & PACKING DATA

INGRESS PROTECTION **IP20**

Cat. No.*	Luminaire Lumen OP (Lm)	Nominal System Wattage (W)	Rated Voltage (V)	Mains Current (A)	Approx. Weight (kg)	Case Lot (in nos)
LD91-141-XXX-65-XX	1045	11	240	0.05	0.54	20
LD91-201-XXX-65-XX	1425	15	240	0.07	0.54	20

65 stands for 6500K. Replace 65 with 40 to get 4000K.

LED is an ever improving and evolving technology. Wipro is committed to bring you the best in LED technology. Data given is representative and can change.





HeliosLED | LD 90

High performance recess mounted LED downlighter



APPLICATIONS



SPECIFICATIONS

- Pressure die-cast aluminium housing
- High transmittivity PC diffuser
- Specially designed, easy to install mounting clips
- Integrated driver & accessories pre-wired
- High efficacy LEDs
- IS 10322 part5/Sec 1 1987 comply

INSTALLATION

- Provision for mounting with the help of specially designed mounting clips

DIMENSION DRAWINGS

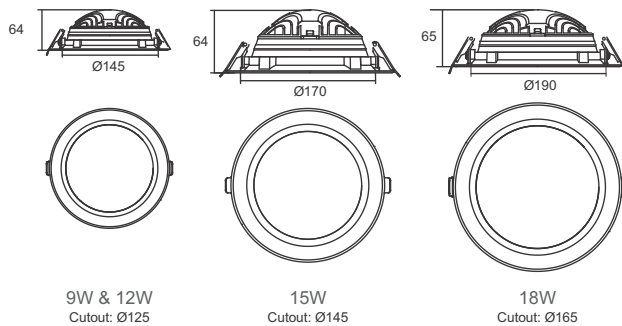

Redefine your workspaces with better illumination and higher savings

- High performance with >95 lumens/W system efficiency
- Glare-free good quality lighting creating cheerful environment
- Specially designed housing ensuring effective thermal management & long service life

ELECTRICAL & PACKING DATA

INGRESS PROTECTION **IP20**

Cat. No.*	Luminaire Lumen OP (Lm)	Nominal System Wattage (W)	Rated Voltage (V)	Mains Current (A)	Case Lot (in nos)
LD90-111-XXX-65-XX	855	9	240	0.04	16
LD90-141-XXX-65-XX	1140	12	240	0.06	16
LD90-191-XXX-65-XX	1425	15	240	0.07	16
LD90-231-XXX-65-XX	1710	18	240	0.08	16

*Other colour temperatures available on request.

LED is an ever improving and evolving technology. Wipro is committed to bring you the best in LED technology. Data given is representative and can change.

IrisLED | LD 71

Recess mounted circular LED downlighter



APPLICATIONS



SPECIFICATIONS

- High efficiency SMD-LED module
- High transmittivity polycarbonate diffuser white powder coated, pressure die-cast aluminium for superior thermal performance
- Aesthetic white rim molded in engineering plastic
- Specially designed, easy to install mounting clips
- Driver pre-wired up to terminal block

INSTALLATION

- Suitable for Armstrong / CRG / TRAC / USG / Celotex / POP modular ceiling system
- Provision for mounting with the help of specially designed mounting clips
- Suitable for ceiling thickness from 6-19 mm

CONTROL GEAR

- Electronic LED driver

DIMENSION DRAWINGS

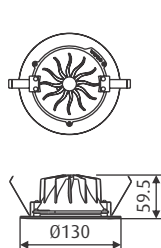

11 W

Cutout dimension : Ø 110 mm

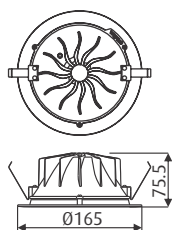

15 W

Cutout dimension : Ø 145 mm

ELECTRICAL & PACKING DATA

INGRESS PROTECTION **IP20**

Cat. No.*	Luminaire Lumen OP (Lm)	Nominal System Wattage (W)	Rated Voltage (V)	Mains Current (A)	Case Lot (in nos)
LD71-111-SMS-65-XX	825	11	240	0.04	12
LD71-161-SML-65-XX	1125	15	240	0.06	12

65 stands for 6500K. Replace 57 and 40 with 65 to get 5700K and 4000K respectively

LED is an ever improving and evolving technology. Wipro is committed to bring you the best in LED technology. Data given is representative and can change.



IrisLED SQ | LD 74

High efficiency square LED downlighter



APPLICATIONS



SPECIFICATIONS

- White powder coated extruded aluminum frame
- High power high efficiency LED module
- Special reflector system with translucent, high transmittivity, non-yellowing diffuser
- LED chips directly mounted on heat sink using thermal paste for effective heat transfer
- Excellent heat dissipation through high purity high thermal conductivity Aluminum heat sink
- Driver pre-wired up to terminal block
- Specially designed mounting clips

INSTALLATION

- Suitable for Armstrong/CRG/TRAC/USG/Celotex/POP modular ceiling system
- Provision for mounting with the help of specially designed mounting clips
- Suitable for ceiling thickness from 6-19 mm

CONTROL GEAR

- Electronic LED driver

DIMENSION DRAWINGS

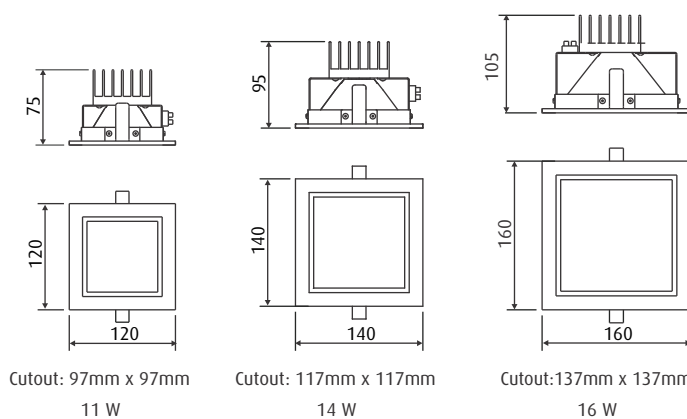

ELECTRICAL & PACKING DATA

INGRESS PROTECTION **IP20**

Cat. No.*	Luminaire Lumen OP (Lm)	Nominal System Wattage (W)	Rated Voltage (V)	Mains Current (A)	Case Lot (in nos)
LD74-101-XXX-65-XX	766	11	240	0.05	8
LD74-121-XXX-65-XX	960	14	240	0.06	8
LD74-151-XXX-65-XX	1160	16	240	0.07	8

*Other colour temperatures available on request.

LED is an ever improving and evolving technology. Wipro is committed to bring you the best in LED technology. Data given is representative and can change.

IrisLED GOLD RF | LD 71

Recess mounted circular LED retrofit downlighter



APPLICATIONS



SPECIFICATIONS

- High efficiency SMD-LED module
- High transmittivity polycarbonate diffuser white powder coated, pressure die-cast aluminium for superior thermal performance
- Aesthetic white rim molded in engineering plastic
- Specially designed, easy to install mounting clips
- Driver pre-wired up to terminal block

INSTALLATION

- Suitable for Armstrong / CRG / TRAC / USG / Celotex / POP modular ceiling system
- Provision for mounting with the help of specially designed mounting clips
- Suitable for ceiling thickness from 6-19 mm

CONTROL GEAR

- Electronic LED driver

DIMENSION DRAWINGS

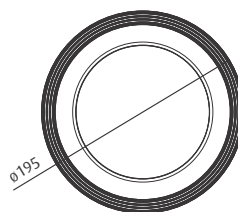

Cutout : 168

All dimensions are in mm. Tolerance ± 2 mm



ELECTRICAL & PACKING DATA

INGRESS PROTECTION **IP20**

Cat. No.*	Luminaire Lumen OP (Lm)	Nominal System Wattage (W)	Rated Voltage (V)	Mains Current (A)	Case Lot (in nos)
LD71-111-SML-65-RF	825	11	240	0.17	12
LD71-161-SML-65-RF	1125	15	240	0.35	12

65 stands for 6500K. Replace 57 and 40 with 65 to get 5700K and 4000K respectively

LED is an ever improving and evolving technology. Wipro is committed to bring you the best in LED technology. Data given is representative and can change.



IrisLED GOLD DD | LD 71

High efficiency LED downlighter with drop down diffuser



APPLICATIONS



SPECIFICATIONS

- High efficiency SMD-LED module
- High transmittivity polycarbonate diffuser white powder coated, pressure die-cast aluminium for superior thermal performance
- Aesthetic white rim molded in engineering plastic
- Specially designed, easy to install mounting clips
- Driver pre-wired up to terminal block

INSTALLATION

- Suitable for Armstrong / CRG / TRAC / USG / Celotex / POP modular ceiling system
- Provision for mounting with the help of specially designed mounting clips
- Suitable for ceiling thickness from 6-19 mm

CONTROL GEAR

- Electronic LED driver



DIMENSION DRAWINGS

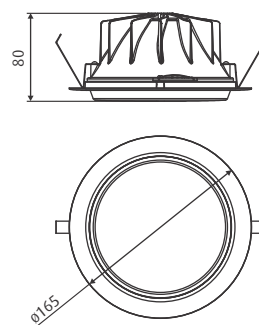

Cutout : 145

All dimensions are in mm. Tolerance ± 2 mm

ELECTRICAL & PACKING DATA

INGRESS PROTECTION **IP20**

Cat. No.*	Luminaire Lumen OP (Lm)	Nominal System Wattage (W)	Rated Voltage (V)	Mains Current (A)	Approx. Weight (kg)	Case Lot (in nos)
LD71-111-SML-65-DD	825	11	240	0.17	0.37	12
LD71-161-SML-65-DD	1125	15	240	0.35	0.50	12

65 stands for 6500K. Replace 57 and 40 with 65 to get 5700K and 4000K respectively

LED is an ever improving and evolving technology. Wipro is committed to bring you the best in LED technology. Data given is representative and can change.

IrisLED GOLD FD | LD 71

Recess mounted LED downlighter with flushed diffuser



APPLICATIONS



SPECIFICATIONS

- High efficiency SMD-LED module
- High transmittivity polycarbonate diffuser white powder coated, pressure die-cast aluminium for superior thermal performance
- Aesthetic white rim molded in engineering plastic
- Specially designed, easy to install mounting clips
- Driver pre-wired up to terminal block

INSTALLATION

- Suitable for Armstrong / CRG / TRAC / USG / Celotex / POP modular ceiling system
- Provision for mounting with the help of specially designed mounting clips
- Suitable for ceiling thickness from 6-19 mm

CONTROL GEAR

- Electronic LED driver

DIMENSION DRAWINGS

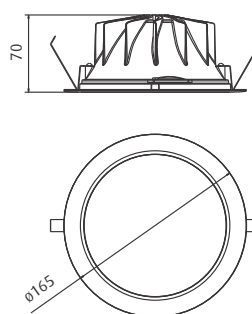

Cutout : 145

All dimensions are in mm. Tolerance ± 2 mm

ELECTRICAL & PACKING DATA

INGRESS PROTECTION **IP20**

Cat. No.*	Luminaire Lumen OP (Lm)	Nominal System Wattage (W)	Rated Voltage (V)	Mains Current (A)	Case Lot (in nos)
LD71-111-SML-65-FD	825	11	240	0.17	12
LD71-161-SML-65-FD	1125	15	240	0.35	12

65 stands for 6500K. Replace 57 and 40 with 65 to get 5700K and 4000K respectively

LED is an ever improving and evolving technology. Wipro is committed to bring you the best in LED technology. Data given is representative and can change.



Halo | CRDL 11

Recess mounted circular LED downlighter



APPLICATIONS



SPECIFICATIONS

- High Luminous Efficacy LEDs
- White powder coated, die cast, LM6 aluminium housing
- Special translucent PMMA diffuser for better light transmission
- High efficient leaf springs in SS202 for ease of recess mounting
- Electronic control gear duly wired up to the terminal block

INSTALLATION

- Provision for mounting with the help of specially designed mounting clips
- Suitable for ceiling thickness from 6-19 mm

DIMENSION DRAWINGS

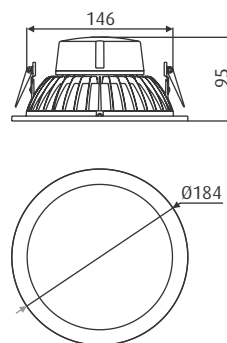

Cutout: Ø172 mm
All dimensions are in mm. Tolerance ± 2 mm

ELECTRICAL & PACKING DATA

INGRESS PROTECTION **IP20**

Cat. No.*	Luminaire Lumen OP (Lm)	Nominal System Wattage (W)	Rated Voltage (V)	Mains Current (A)	Approx. Weight (kg)	Case Lot (in nos)
CRDL11R008HP57	595	6	240	0.02	0.6	08
CRDL11R013HP57	895	9	240	0.04	0.6	08
CRDL11R017HP57	1195	12	240	0.05	0.6	08
CRDL11R023HP57	1695	18	240	0.08	0.6	08

*Other colour temperatures available on request.

LED is an ever improving and evolving technology. Wipro is committed to bring you the best in LED technology. Data given is representative and can change.



Halo | CRDL 11

Recess mounted circular LED downlighter



APPLICATIONS



SPECIFICATIONS

- Spun housing made of 1.0mm thick aluminium sheet & white powder coated finish
- Die cast heat sink with black powder coating for better aesthetics and functionality
- Special translucent PMMA diffuser for better light transmission
- High luminous flux imported LEDs for better light output
- Easy to mount on Grid/POP and quick to service; High efficient Torsional springs for ease of recess mounting
- Electronic control gear duly wired up to the terminal block
- Fixture is enabled with Analog dimming
- Designed and manufactured to comply with IS 10322 part 5/Sec 1 1987

INSTALLATION

- Suitable for true ceiling/Grid/POP

DIMENSION DRAWINGS

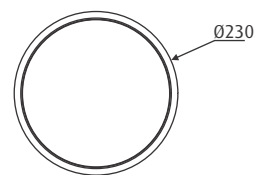
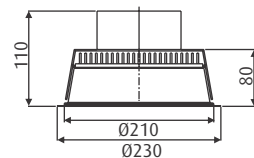

Cutout: Ø220mm
All dimensions are in mm. Tolerance ± 2 mm

ELECTRICAL & PACKING DATA

INGRESS PROTECTION **IP20**

Cat. No.*	Luminaire Lumen OP (Lm)	Nominal System Wattage (W)	Rated Voltage (V)	Mains Current (A)	Approx. Weight (kg)	Case Lot (in nos)
CRDL11R033HP57	2690	26	240	0.11	1.4	04

*Other colour temperatures available on request.

LED is an ever improving and evolving technology. Wipro is committed to bring you the best in LED technology. Data given is representative and can change.

Halo | CRDL 11

Surface mounted circular LED downlighter



APPLICATIONS



SPECIFICATIONS

- High Luminous Efficacy LEDs
- White powder coated, die cast, LM6 aluminium housing
- Special translucent PMMA diffuser for better light transmission
- High efficient leaf springs in SS202 for ease of recess mounting
- Electronic control gear duly wired up to the terminal block

INSTALLATION

- Cylindrical skirt made of CRCA 0.5mm thick and white powder coated for surface mounting
- Bracket to Mount on true ceiling made of 1.6mm CRCA, zinc blue passivated

DIMENSION DRAWINGS

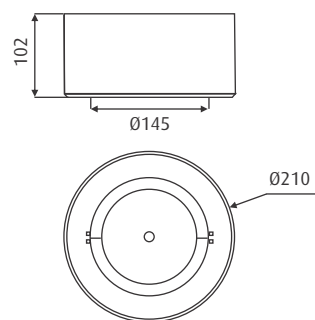

All dimensions are in mm. Tolerance ± 2 mm

ELECTRICAL & PACKING DATA

INGRESS PROTECTION **IP20**

Cat. No.*	Luminaire Lumen OP (Lm)	Nominal System Wattage (W)	Rated Voltage (V)	Mains Current (A)	Approx. Weight (kg)	Case Lot (in nos)
CRDL11S008HP57	595	6	240	0.02	1.2	04
CRDL11S013HP57	895	9	240	0.04	1.2	04
CRDL11S017HP57	1195	12	240	0.05	1.2	04
CRDL11S023HP57	1695	18	240	0.08	1.2	04

*Other colour temperatures available on request.

LED is an ever improving and evolving technology. Wipro is committed to bring you the best in LED technology. Data given is representative and can change.



Halo | CRDL 11

Surface mounted circular LED downlighter



APPLICATIONS



SPECIFICATIONS

- Spun housing made of 1.0mm thick aluminium sheet & white powder coated finish
- Die cast heat sink with black powder coating for better aesthetics and functionality
- Special translucent PMMA diffuser for better light transmission
- High luminous flux imported LEDs for better light output
- Easy to mount on True ceiling/ Grid/POP and quick to service; High efficient Torsional springs for ease of recess mounting; White powder coated bracket in 2mm Thick CRCA for surface mounting
- Cylindrical skirt made of CRCA 0.5mm thick and white powder coated for surface mounting
- Electronic control gear duly wired up to the terminal block
- Designed and manufactured to comply with IS 10322 part 5/Sec 1 1987

INSTALLATION

- Suitable for surface mounting

DIMENSION DRAWINGS

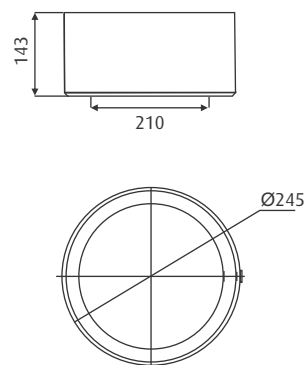

All dimensions are in mm. Tolerance ± 2 mm

ELECTRICAL & PACKING DATA

INGRESS PROTECTION **IP20**

Cat. No.*	Luminaire Lumen OP (Lm)	Luminaire Wattage (W)	Rated Voltage (V)	Mains Current (A)	Approx. Weight (kg)	Case Lot (in nos)
CRDL11S033HP57	2681	26	240	0.11	1.7	04

*Other colour temperatures available on request.

LED is an ever improving and evolving technology. Wipro is committed to bring you the best in LED technology. Data given is representative and can change.

LED Gimball | LD 56

Circular gimball luminaire



APPLICATIONS



SPECIFICATIONS

- Aluminium die cast construction with white powder coating
- Clear safety glass
- High power high lumen output LED
- High efficiency reflector optics
- Effective thermal management using aluminium casting
- Constant current driver

INSTALLATION

- Provision for mounting with the help of mounting clips with springs for ease of installation and maintenance
- Suitable for mounting in POP, Gypsum board and any other false ceiling



DIMENSION DRAWINGS

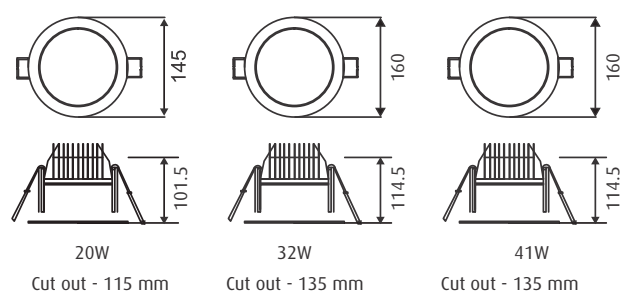

Beam angles: 16°, 24°, 36°, 60°

All dimensions are in mm. Tolerance ± 2 mm

ELECTRICAL & PACKING DATA

INGRESS PROTECTION **IP20**

Cat. No.*	Luminaire Lumen OP (Lm)	Nominal System Wattage (W)	Rated Voltage (V)	Mains Current (A)	Case Lot (in nos)
LD56-251-060-40-XX	2080	20	240	0.09	12
LD56-381-060-40-XX	3328	32	240	0.14	20
LD56-501-060-40-XX	4264	41	240	0.18	20

*Other colour temperatures and beam angles available on request.

LED is an ever improving and evolving technology. Wipro is committed to bring you the best in LED technology. Data given is representative and can change.



LED Tracklight | LD 57

LED Track Light



APPLICATIONS



SPECIFICATIONS

- Aluminium die cast construction with white powder coating
- Clear glass 1mm thick
- High power high lumen output LED
- High efficiency reflector optics
- Effective thermal management using aluminium casting
- Constant current driver
- Integral track adaptor with special track locking system to ensure proper mounting on track



INSTALLATION

- Provision for mounting on track using track adaptor to install and lock the spotlight firmly to the track
- 3 nos. of LD57 can be installed per metre track

DIMENSION DRAWINGS

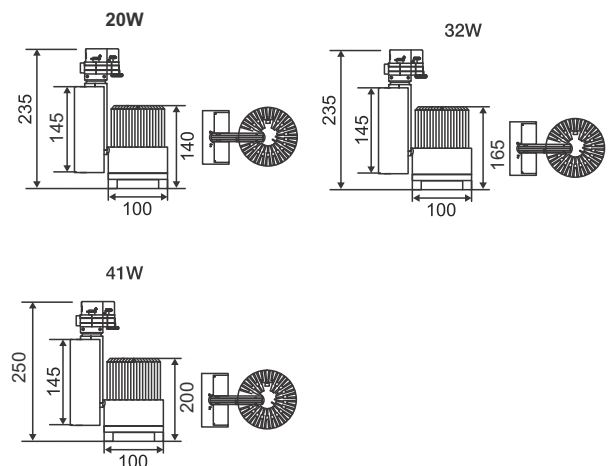

Beam angles - 24°, 36°, 60°

All dimensions are in mm. Tolerance ± 2 mm

ELECTRICAL & PACKING DATA

INGRESS PROTECTION **IP20**

Cat. No.*	Luminaire Lumen OP (Lm)	Nominal System Wattage (W)	Rated Voltage (V)	Mains Current (A)	Case Lot (in nos)
LD57-251-036-40-XX	2080	20	240	0.08	18
LD57-381-036-40-XX	3328	32	240	0.14	18
LD57-501-036-40-XX	4264	41	240	0.18	12

*Other colour temperatures available on request.

LED is an ever improving and evolving technology. Wipro is committed to bring you the best in LED technology. Data given is representative and can change.

LED Gimball | LD 58

Square gimball luminaire



APPLICATIONS



SPECIFICATIONS

- Aluminium die cast construction with white powder coating
- Clear glass 1mm thick
- High power high lumen output LED
- High efficiency reflector optics with choice of beam angles
- Effective thermal management using aluminium casting
- Constant current driver

INSTALLATION

- Provision for mounting with the help of mounting clips with springs for ease of installation and maintenance
- Suitable for mounting in POP, Gyp board and any other false ceiling



DIMENSION DRAWINGS

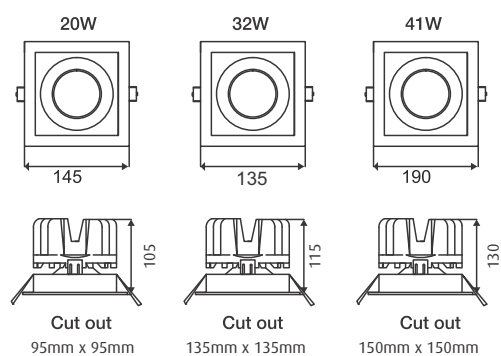

Beam angles - 16°, 24°, 36°, 60°
All dimensions are in mm. Tolerance ± 2 mm

ELECTRICAL & PACKING DATA

INGRESS PROTECTION **IP20**

Cat. No.*	Luminaire Lumen OP (Lm)	Nominal System Wattage (W)	Rated Voltage (V)	Mains Current (A)	Case Lot (in nos)
LD58-251-060-40-XX	2080	20	240	0.08	20
LD58-381-060-40-XX	3328	32	240	0.14	20
LD58-501-060-40-XX	4264	41	240	0.18	20

*Other colour temperatures available on request. Available in double/triple configurations as well.

LED is an ever improving and evolving technology. Wipro is committed to bring you the best in LED technology. Data given is representative and can change.



LED Swivel Projector | LD 59

Circular adjustable/rotatable downlight luminaire



APPLICATIONS



SPECIFICATIONS

- Aluminium die-cast construction with white powder coating
- Clear Safety Glass
- High power high lumen output COB LED
- High efficiency reflector optics
- Rotatable upto 360° and adjustable upto 45°
- Effective thermal management using aluminium casting

INSTALLATION

- Provision for mounting with the help of mounting clips with springs for ease of installation and maintainence
- Suitable for mounting in POP, Gypsum board and any other false ceiling



DIMENSION DRAWINGS

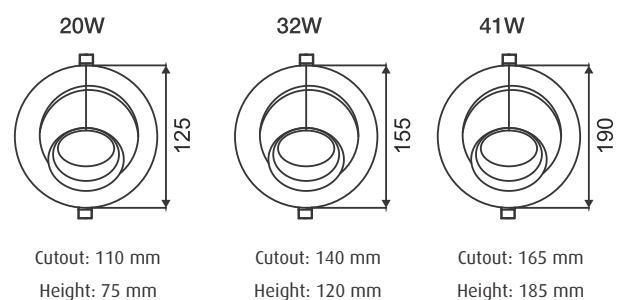

Beam angles - 16°, 24°, 36°, 60°

All dimensions are in mm. Tolerance ± 2 mm

ELECTRICAL & PACKING DATA

INGRESS PROTECTION **IP20**

Cat. No.*	Luminaire Lumen OP (Lm)	Nominal System Wattage (W)	Rated Voltage (V)	Mains Current (A)	Case Lot (in nos)
LD59-251-036-40-XX	2080	20	240	0.08	20
LD59-381-036-40-XX	3328	32	240	0.14	18
LD59-501-036-40-XX	4264	41	240	0.18	8

*Other colour temperatures available on request.

LED is an ever improving and evolving technology. Wipro is committed to bring you the best in LED technology. Data given is representative and can change.